

**Why** Daily cleaning for Espresso machine. The Melitta espresso machine must be cleaned at least once a day to ensure a quality product and trouble free operation.

**Time required** 1 minute to prepare 20 minutes to complete

**Time of day** At store closing For 24-hour restaurants: Between 10:30am – 12:30pm  
2<sup>nd</sup> daily cleaning of higher volume stores (+500 drinks per week) during the day – Managers preference.

**Hazard icons**  Chemicals  Hot Liquids/Steam  Equipment Alert

### Tools and supplies



Combination Cleaning  
Tabs



Delimer



Paper towels



Cleaning  
Pitcher



Bucket, clean and  
sanitized towels

### Daily Cleaning Procedure

#### 1 Starting the cleaning cycle

Touch the tab for the cleaning menu and then press **"Clean full system"**, if you want to clean the machine and would like to continue operation. **"Clean and switch off full system"**, if you want the machine cleaned and switched off at the end of the cleaning cycle.



Cleaning menu tab

#### 2 Run the cleaning cycle

*Do you want to start the cleaning process?*  
*The cleaning process cannot be cancelled*  
**If yes, press "next"**  
**If no, press "cancel"**

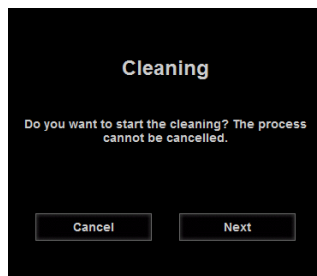

#### 3 Empty the waste drawer

Press to open the (1) waste drawer door and pull out the (2) waste drawer. Empty the drawer and insert the clean drawer into the original position, close the door and confirm by pressing **"Close."**

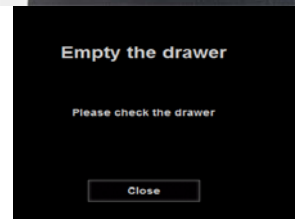

#### 4 Insert the cleaning pitcher

Open the refrigerator and remove the milk connectors from the milk bags. Place the milk lines in the empty cleaning pitcher. Make sure the connectors are at the bottom of the pitcher. Immediately carry the remaining milk to the walk-in cooler for storage.



# Daily Cleaning Cycle (continued)

## 5 Milk system cleaning

### *Cleaning agent milk system*

Appears on the display, place 2 cleaning tablets into the cleaning pitcher. Touch **"Cleaning agent was added"**

### Wed and Sunday use delimer

Wednesdays and Sundays use 1 delimer packet in place of cleaning tablets. This is essential to help remove milk stone from the milk system. Pitcher fills with hot water automatically and empties automatically. There is no need to fill the pitchers with water.



Chemicals

**Only use Melitta approved cleaning products.**



Wednesdays and Sundays use delimer



## 6 Open unit door and remove tablet retainer

As soon as *cleaning agent brewing system* appears on the display, unlock the unit door with the knob and remove the (1) tablet retainer by turning it a quarter of a turn counter-clockwise.



## 7 Insert cleaning tablet into tablet retainer

Place a (1) cleaning tablet in the tablet retainer and turn the tablet retainer a quarter of a turn clockwise so that it is locked in the machine and close the unit door.



Chemicals



Tip

**Only use Cafina/Melitta approved cleaning products**

**Equipment Alert**

**Never place Delimer in cleaning tablet compartment**



## 8 Cleaning agent brewing system

Confirm the insertion of the cleaning tablet by touching **"Cleaning tablet is inserted"** The machine is now being cleaned. The remainder of the process requires no further action and will take 16min to complete.

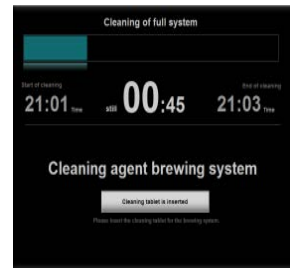

## 9 \*Caution\*

**Hot water will flow from the spout and fill the pitcher during cleaning. Move spout to the lowest position to reduce splashing.**



Hot Liquids/Steam

## 10 Remove cleaning pitcher

When the cleaning cycle has finished, remove the milk connectors from the cleaning pitcher, and wipe connectors with a sanitized towel.



## 11 Continued operation

If operation of the machine is to be continued, place milk bags in the refrigerator and insert the milk connectors in milk bags.

